



HIGH OUTPUT

495 Turnpike Street
Canton, MA 02021

781-364-1800
www.highoutput.com

Drawing Name:

**Charles River Studios
Studio C
Floorplan**

Version: 1 Plate #: 1

Date Created: November 20, 2019

Drwn By: N. Jewett

Scale: 1/8" = 1'-0"
(Printed at 100% on 8.5"x11" Paper)

Client:

Account Manager:

Project Manager:

Event Date/Location:

Notes:

- Total Area ~2400 sq. ft.
- Steel Working Height:
 - 24' to high steel
 - 21' to low steel
- Overhead Door to Studio C:
 - 9'10" h x 7'10" wide
- Power: 200a/3ph
- Standard Flat Black painted floor surface over concrete.
- Standard flat white painted seamless cyc on two walls.

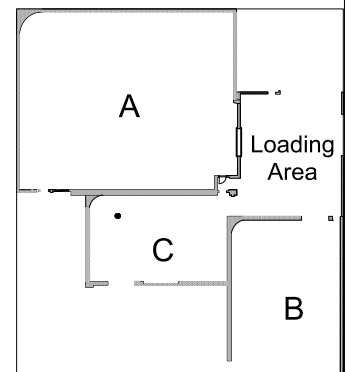
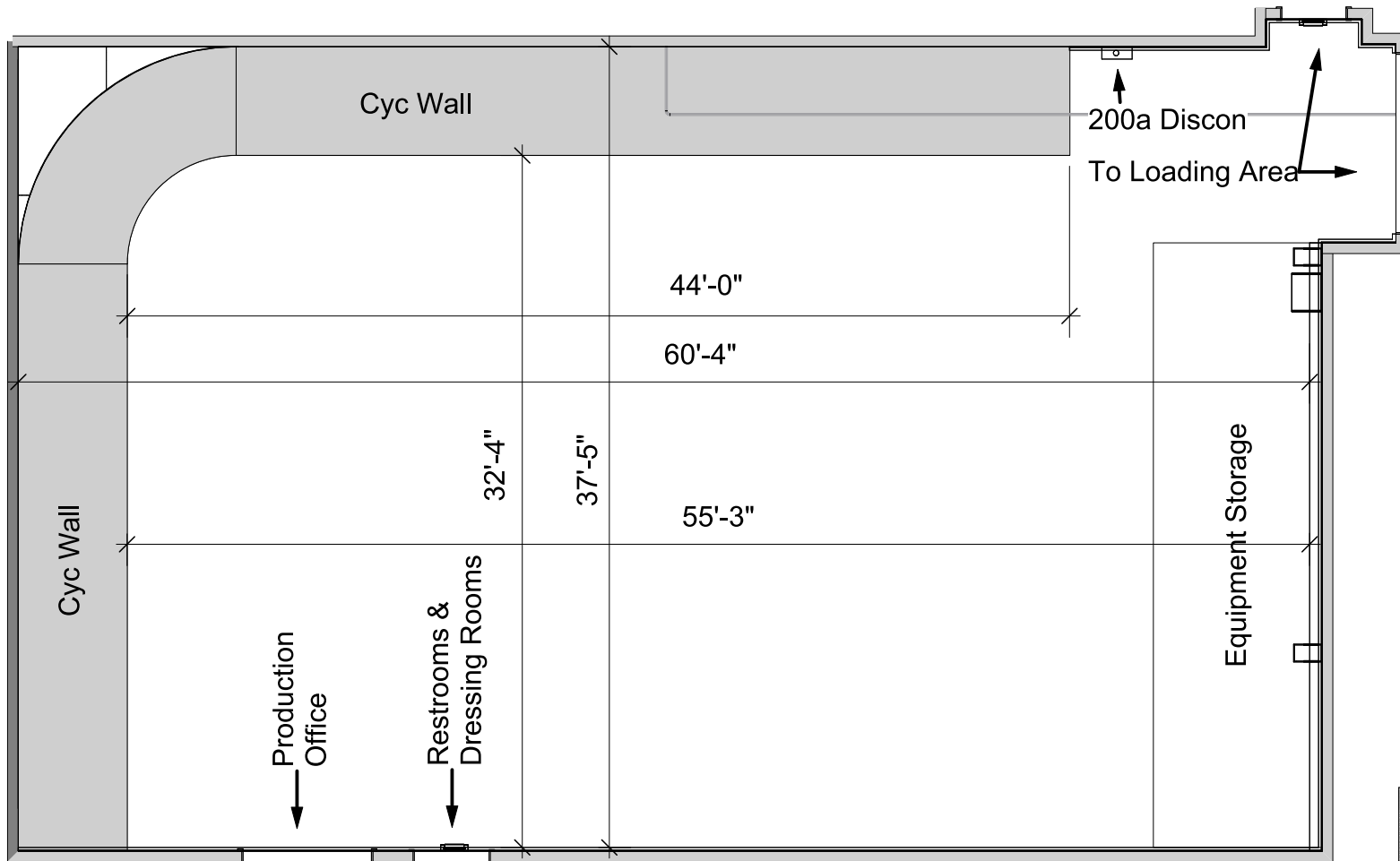



HIGH OUTPUT

495 Turnpike Street
Canton, MA 02021

781-364-1800
www.highoutput.com

Drawing Name:

**Charles River Studios
Studio C
Overhead**

Version: 1 Plate #: 1

Date Created: November 20, 2019

Drwn By: N. Jewett

Scale: 1/8" = 1'-0"
(Printed at 100% on 8.5"x11" Paper)

Client:

Account Manager:

Project Manager:

Event Date/Location:

Notes:

- Total Area ~2400 sq. ft.
- Steel Working Height:
 - 24' to high steel
 - 21' to low steel
- Overhead Door to Studio C:
 - 9'10" h x 7'10" wide
- Power: 200a/3ph
- Standard Flat Black painted floor surface over concrete.
- Standard flat white painted seamless cyc on two walls.

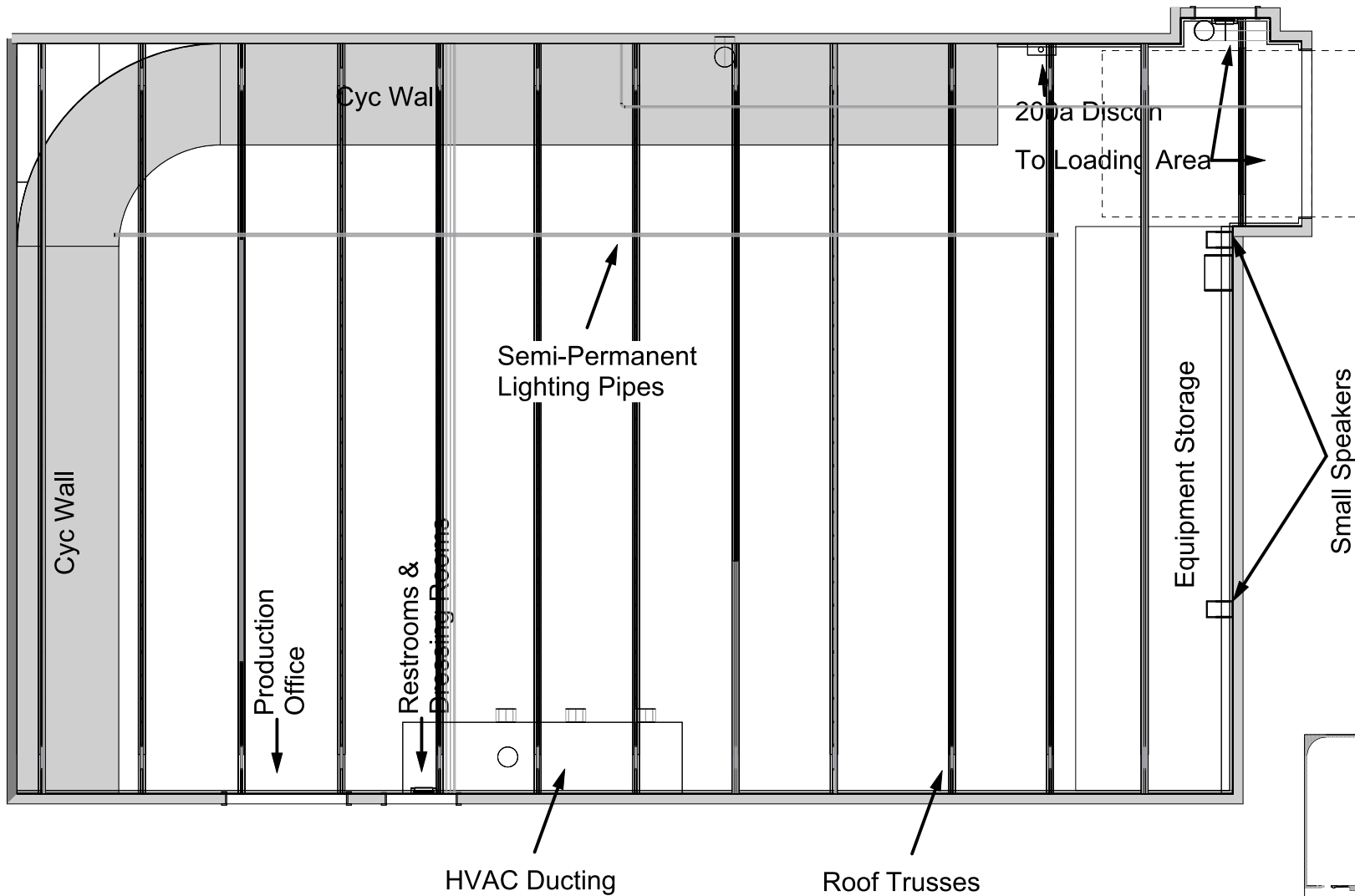

3-Dimensional Vectorworks Drawing available upon request

